

Features

Small size and high contact rating
High temperature design
Ideal for use in automotive control
Metal cover & direct coupling type



Ordering information

FRC11 A - 2 N DC12V

1 2 3 4 5

1 Relay model
2 Contact rating: A: 1 Form A
3 Mounting terminal: NIL: Plain dust cover type;
2 : Metal bracket dust cover
4 Coil suppression: NIL: Standard type; N: With diode;
R : With resistor

5 Rated voltage
Note: RoHS : RoHS compliant relay
RoHS-I : AgNi contact
RoHS-N: AgSnO₂ contact

Coil rating

| Rated voltage (V) | Coil resistance Ω +/- 10% | Must operate voltage % of rated voltage (at 20°C) | Must dropout voltage 5 Min. | Maximum voltage 150 Max. | Power consumption (W) Approx. | Operate time (ms) | Release time (ms) |
|----------------------|-------------------------------------|--|--------------------------------|-----------------------------|----------------------------------|----------------------|----------------------|
| 12 24 | 100 384 | 65 Max. | | | 1.5 | <10 | <7 |

CAUTION: 1. The use of any coil voltage less than the rated coil voltage will compromise the operation of the relay.
2. Pickup and release voltage are for test purposes only and are not to be used as design criteria.

Characteristics

| | |
|----------------------------|--|
| Contact arrangement | SPST (1 Form A) |
| Contact material | Silver alloy |
| Contact resistance | 50m Ω Max. |
| Contact rating (resistive) | 40A 14VDC |
| Switching power | 560W Max. |
| Switching voltage | DC 75V Max. |
| Insulation resistance | 100M Ω Min. (at 500VDC) |
| Dielectric strength | 500VAC (50Hz/min) |
| Shock resistance | 20g Approx. |
| Vibration resistance | 1.5mm Double amplitude 10-40Hz |
| Ambient temperature | -40°C to +85°C (Special request: +105°C) |
| Humidity | 85% RH, 40°C |
| Operation life | Mechanical 10 ⁶ Electrical 10 ⁵ |
| Weight | FRC11: 35g Approx.; FRC11-2: 38g Approx. |

(Specifications are subject to change without notices.)

Dimensions

mm

FRC11

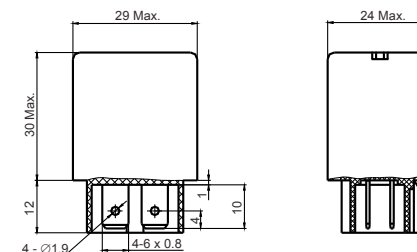

FRC11-2

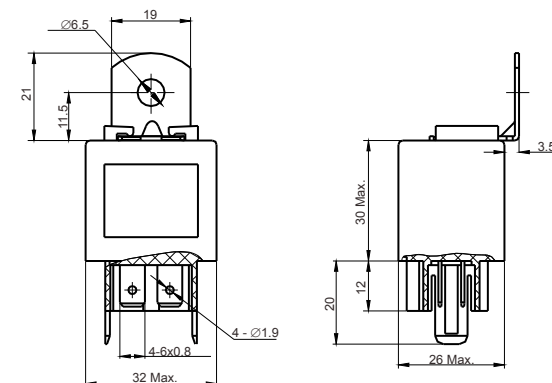

Mounting holes

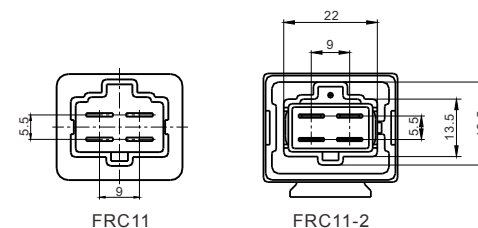

FRC11

FRC11-2

Wiring diagram

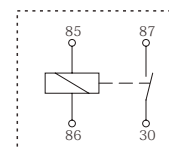

1 Form A

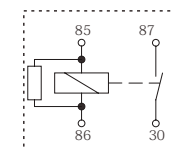

With resistor

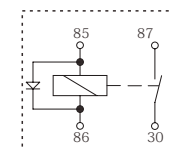

With diode